

1.25 (✓)

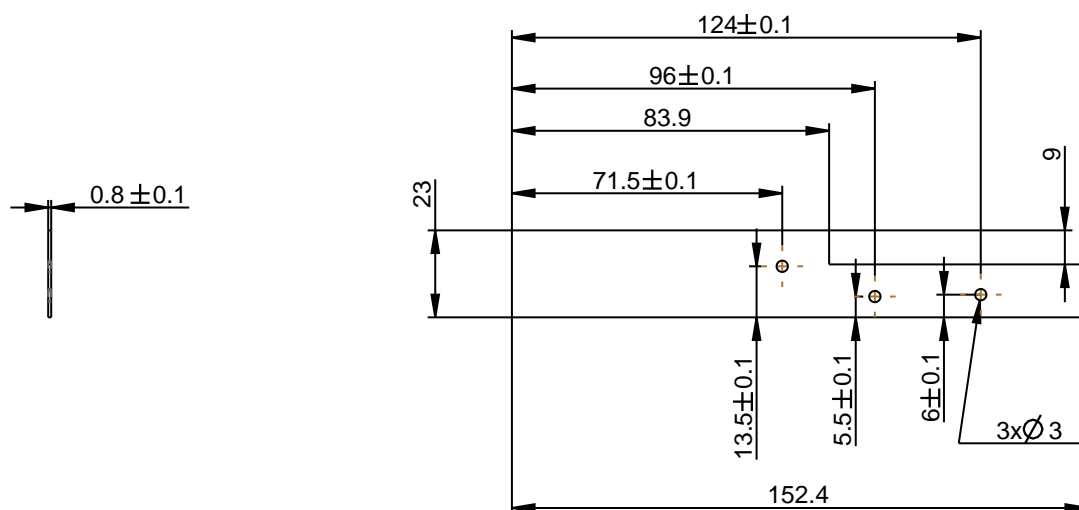

All tolerances: $\pm t1/2$, -t1, -t1 All edges: 0,2x45 ° (unless otherwise specified)

According ISO 2768-1-f	Tolerance	±t1/2	±0.05	±0.05	±0.1	±0.15	±0.2	±0.3	±0.1 °
	Dimension range		0.5-3	3-6	6-30	30-120	120-400	400-1000	Angular
X			X	Copper		X		Use tol. -t1 for outside and +t1 for inside dimensions.	
Part Description			Q.	Material		Dimensions			
Designer		Date	Scale	Size					
Angel Marinov		13-Dec-09	1 / 1	A4					
X		X	Projection						
File	STRIP1				Project name		Rev.		
ESD #	X				Project number		1.0		
Class	X				Part name		STRIP1		Sheet 1 ¹