

1.25 (✓)

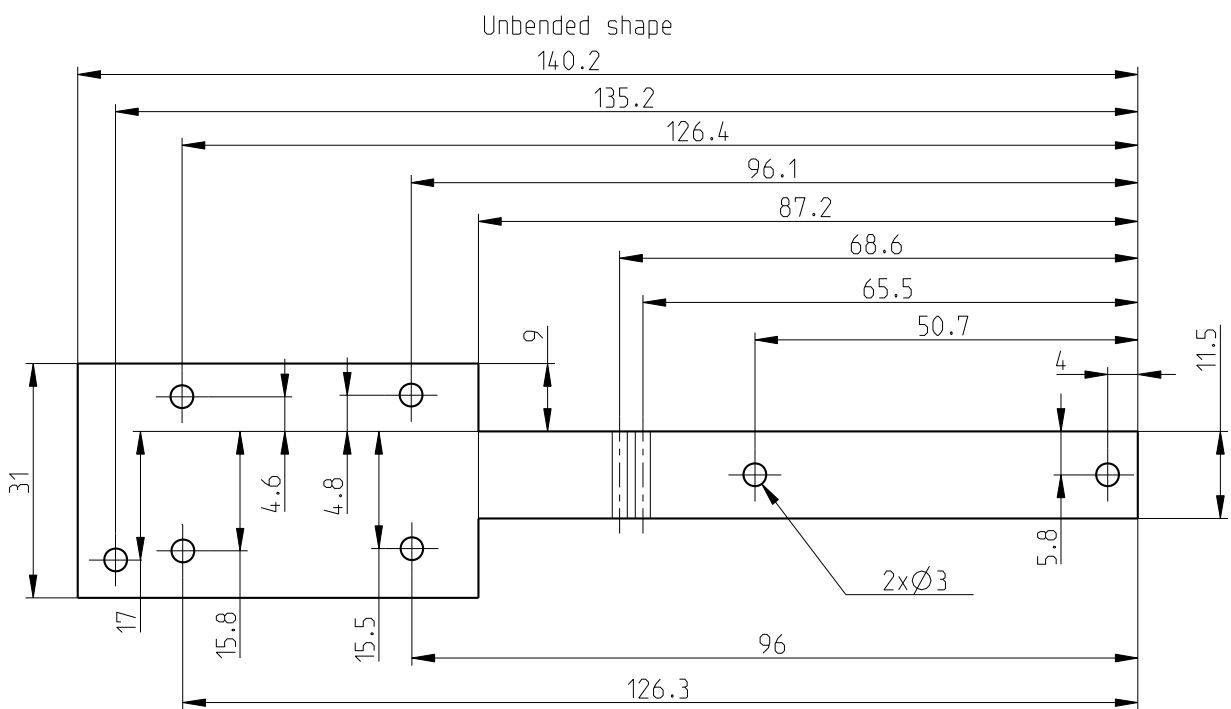
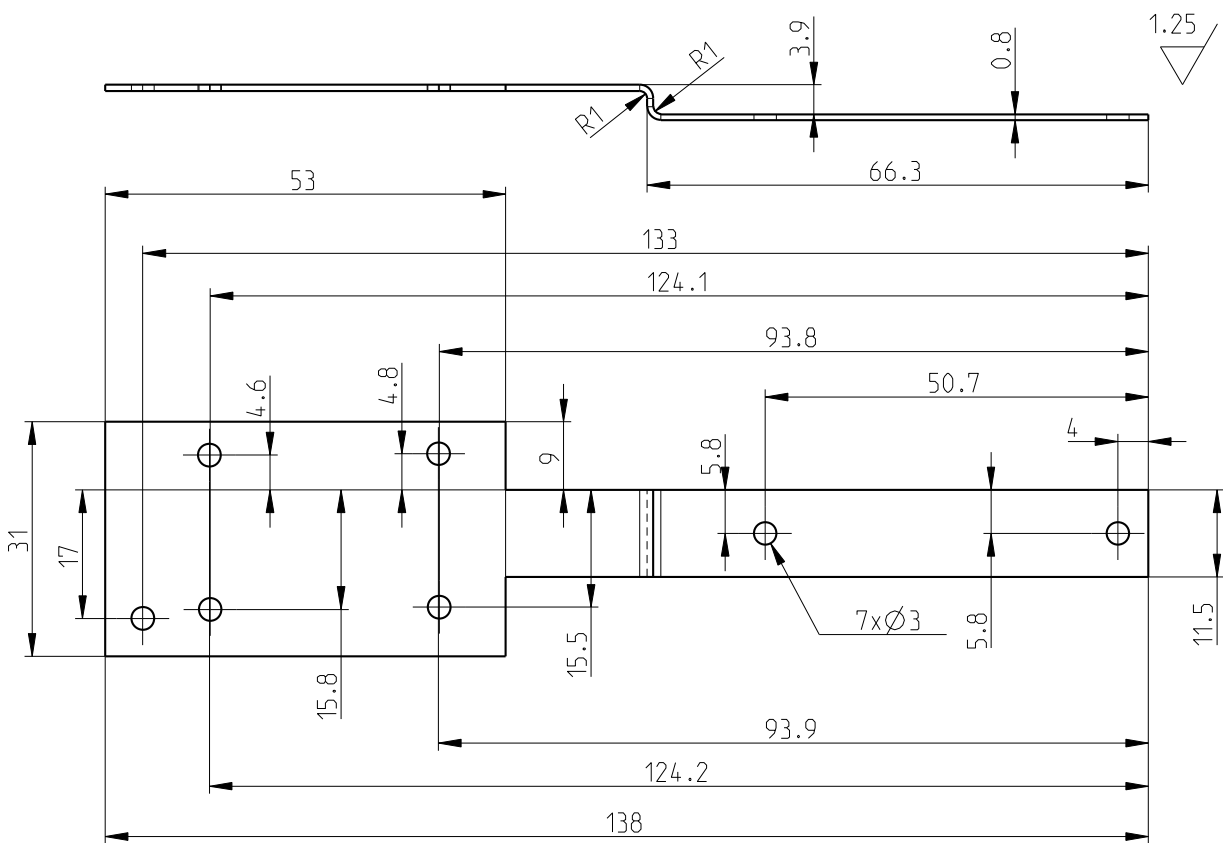

All thread hole positions tolerance -  $\pm 0.1$

All tolerances:  $\pm t/2$ ,  $-t$ ,  $-t$  All edges:  $0,2 \times 45^\circ$  (unless otherwise specified)

|                        |                     |            |                        |                |            |           |   |                 |
|------------------------|---------------------|------------|------------------------|----------------|------------|-----------|---|-----------------|
| According ISO 2768-1-f | Tolerance $\pm t/2$ | $\pm 0.05$ | $\pm 0.05$             | $\pm 0.1$      | $\pm 0.15$ | $\pm 0.2$ | $\pm 0.3$   | $\pm 0.1^\circ$ |
|                        | Dimension range     | 0.5-3      | 3-6                    | 6-30           | 30-120     | 120-400   | 400-1000  | Angular         |
| X                      |                     | X          | C10100 (99.99% copper) |                | X          |           | Use tol. $-t$ for outside and $+t$ for inside dimensions. |                 |
| Part Description       |                     | Q.         | Material               |                | Dimensions |           |   |                 |
| Designer               | Date                | Scale      | Size                   |                | A S M E    |           |   |                 |
| Angel Marinov          | 07-Mar-10           | 1 / 1      | A4                     |                |            |           |   |                 |
| X                      | X                   | Projection |                        |                |            |           |   |                 |
| File                   | STRIP2              |            |                        | Project name   | C90S       | Rev.      |   |                 |
| ESD #                  | X                   |            |                        | Project number | I          | 1.0       |   |                 |
| Class                  | X                   |            |                        | Part name      | STRIP2     | Sheet 1/1 |   |                 |